

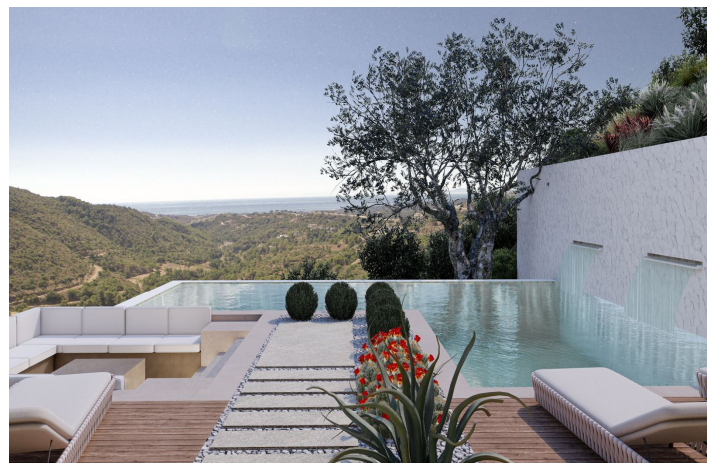

Detached Villa for sale in Benahavís, Benahavís

2,350,000 €

Reference: R4678027 Bedrooms: 5 Bathrooms: 6 Plot Size: 2,775m² Build Size: 633m² Terrace: 233m²





Costa del Sol, Benahavís

Presenting a contemporary Turnkey Signature Villa designed across two angled levels. A grand XXL window feature graces the spacious hall, creating a comfortable layout that separates sleeping quarters from the main living and entertainment spaces. Accessed from the upper level, the modern home boasts a sleek driveway with wooden accents leading to a covered parking area for 2 cars.

The top-floor master suite includes a dressing room and spacious bathroom, complemented by a private terrace offering relaxing views of the surrounding nature. Just below, in the same wing, you'll find 4 ample ensuite bedrooms, each with a dressing area and sliding doors to the garden. Further on the lower level, the southwest-facing section of the villa is thoughtfully designed to benefit from the natural sunlight. An open-plan kitchen, dining, and living area layout, extends to outdoor spaces perfect for dining and lounging, around a tempting swimming pool. A special sunken lounge area with a fire pit adds a touch of enchantment to starlit evenings. Nestled in the prestigious MonteMayor enclave within the renowned municipality of Benahavís, this gated community boasts 24-hour surveillance security amidst a stunning natural setting. Located between Marbella and Estepona, it's a short drive from coastal beaches, amenities, leisure spots, shopping areas, and some of the finest golf courses.

- Build on 2 Levels
- 5 Bedrooms En Suite
- Open Plan Living area
- Fully Fitted Kitchen and Bathrooms
- Covered Parking for 2 Cars
- Gated community w/ 24 hr Security
- Turnkey Delivery, with highest quality standards and maximal structural guarantees.



Features:

Features

Covered Terrace
Lift
Near Transport
Private Terrace
Storage Room
Ensuite Bathroom
Marble Flooring
Double Glazing
Fitted Wardrobes
WiFi
Gym
Sauna
Utility Room
Near Church
Basement

Setting

Close To Golf
Close To Shops
Close To Town
Country

Kitchen

Fully Fitted

Parking

Private
Covered
More Than One

Climate Control

Air Conditioning
Pre Installed A/C
Cold A/C
Hot A/C
U/F Heating
U/F/H Bathrooms

Condition

New Construction

Garden

Private
Landscaped
Easy Maintenance

Utilities

Electricity
Drinkable Water

Views

Sea
Mountain
Panoramic
Garden
Pool

Pool

Private

Security

Gated Complex
Entry Phone

Category

Holiday Homes
Investment
Golf
Luxury
Off Plan